

SPECIAL ISSUE



THE KENYA GAZETTE

Published by Authority of the Republic of Kenya

(Registered as a Newspaper at the G.P.O.)

Vol. CXXVI—No. 72

NAIROBI, 28th May, 2024

Price Sh. 60

GAZETTE NOTICE No. 6465

THE LAND REGISTRATION ACT

(No. 3 of 2012)

THE LAND REGISTRATION (REGISTRATION UNITS) ORDER, 2017

CONVERSION AND MIGRATION

PURSUANT to regulation 4 (4) of the Land Registration (Registration Units) Order, 2017, the Cabinet Secretary for Lands and Physical Planning, having received from the Registrar conversion list and cadastral maps in respect of Nairobi Land Registration Unit, hereby notifies the general public that land reference numbers specified in the first column of the Schedule have been converted to new parcel numbers, specified in the second column thereof, with corresponding area respectively specified in the third column.

Any person with an interest in land within the registration unit who is aggrieved by the information in the conversion list or the cadastral maps is invited, within the next ninety (90) days from the date of publication of this notice to —

- make a complaint, in writing in Form LRA 96 set out in the Second Schedule to the Land Registration (Registration Units) Order, 2017, to the Registrar in respect of the information contained in the conversion list and the cadastral maps; or
- apply to the Registrar in Form LRA 67 set out in the Sixth Schedule to the Land Registration (General) Regulations, 2017 for the registration of a caution pending the clarification or resolution of any complaint.

The conversion lists and cadastral maps can also be accessed from—

- Ministry of Lands and Physical Planning, Ardhi House, 1st Ngong Avenue, Nairobi
- Department of Surveys (Survey of Kenya), Ruaraka
- Ministry website: <https://lands.go.ke>

All transactions or dealings relating to parcels affected by the notice shall from the 2nd September, 2024 be carried out in the new registers.

SCHEDULE

NAIROBI/BLOCK 149

(LANGATA)

| Old L.R. No. | New Parcel No. | Area (Ha.) |
|--------------|------------------------|------------|
| 26695/212 | Nairobi Block 149/1917 | 0.054 |
| 19952/753 | Nairobi Block 149/1918 | 0.2142 |
| 19952/759 | Nairobi Block 149/1930 | 0.0171 |
| 19952/758 | Nairobi Block 149/1929 | 0.0177 |
| 19952/757 | Nairobi Block 149/1928 | 0.0314 |
| 26695/218 | Nairobi Block 149/949 | 0.0466 |
| 26695/2 | Nairobi Block 149/1575 | 0.049 |
| 26695/3 | Nairobi Block 149/1576 | 0.034 |
| 26695/4 | Nairobi Block 149/1577 | 0.034 |
| 26695/5 | Nairobi Block 149/1578 | 0.034 |
| 26695/6 | Nairobi Block 149/1579 | 0.034 |
| 26695/7 | Nairobi Block 149/1580 | 0.0306 |
| 26695/8 | Nairobi Block 149/1581 | 0.0306 |
| 26695/9 | Nairobi Block 149/1582 | 0.0306 |
| 26695/10 | Nairobi Block 149/1583 | 0.0306 |
| 26695/11 | Nairobi Block 149/1584 | 0.0306 |
| 26695/12 | Nairobi Block 149/1585 | 0.0306 |
| 26695/13 | Nairobi Block 149/1586 | 0.0306 |
| 26695/14 | Nairobi Block 149/1587 | 0.0234 |
| 26695/15 | Nairobi Block 149/1588 | 0.0234 |
| 26695/16 | Nairobi Block 149/1589 | 0.0234 |
| 26695/17 | Nairobi Block 149/1590 | 0.0234 |
| 26695/18 | Nairobi Block 149/1591 | 0.0283 |
| 26695/209 | Nairobi Block 149/3382 | 0.0453 |
| 26695/208 | Nairobi Block 149/3381 | 0.0432 |
| 26695/207 | Nairobi Block 149/3380 | 0.0395 |
| 26695/210 | Nairobi Block 149/3384 | 0.0408 |
| 26695/206 | Nairobi Block 149/3379 | 0.0282 |
| 26695/205 | Nairobi Block 149/3378 | 0.0277 |
| 26695/202 | Nairobi Block 149/3375 | 0.0262 |
| 26695/201 | Nairobi Block 149/3374 | 0.0258 |
| 26695/200 | Nairobi Block 149/3373 | 0.0253 |
| 26695/199 | Nairobi Block 149/3372 | 0.0248 |
| 26695/198 | Nairobi Block 149/3371 | 0.0243 |
| 26695/197 | Nairobi Block 149/3370 | 0.0238 |
| 26695/196 | Nairobi Block 149/3369 | 0.0233 |
| 26695/195 | Nairobi Block 149/3368 | 0.0288 |

| <i>Old L.R. No.</i> | <i>New Parcel No.</i> | <i>Area (Ha.)</i> |
|---------------------|------------------------|-------------------|
| 26695/192 | Nairobi Block 149/3365 | 0.0237 |
| 26695/191 | Nairobi Block 149/3364 | 0.0231 |
| 26695/190 | Nairobi Block 149/3363 | 0.0247 |
| 26695/189 | Nairobi Block 149/3362 | 0.0239 |
| 26695/188 | Nairobi Block 149/3361 | 0.0232 |
| 26695/187 | Nairobi Block 149/3360 | 0.0225 |
| 26695/166 | Nairobi Block 149/3339 | 0.0429 |
| 26695/165 | Nairobi Block 149/3338 | 0.0225 |
| 26695/164 | Nairobi Block 149/3337 | 0.0225 |
| 26695/163 | Nairobi Block 149/3336 | 0.0225 |
| 26695/162 | Nairobi Block 149/3335 | 0.0225 |
| 26695/161 | Nairobi Block 149/3334 | 0.0225 |
| 26695/160 | Nairobi Block 149/3333 | 0.0225 |
| 26695/159 | Nairobi Block 149/3332 | 0.0225 |
| 26695/158 | Nairobi Block 149/3331 | 0.0225 |
| 26695/157 | Nairobi Block 149/3330 | 0.0225 |
| 26695/156 | Nairobi Block 149/3329 | 0.0458 |
| 26695/211 | Nairobi Block 149/3385 | 0.0338 |
| 26695/155 | Nairobi Block 149/3328 | 0.0225 |
| 26695/154 | Nairobi Block 149/3327 | 0.0225 |
| 26695/153 | Nairobi Block 149/3326 | 0.0225 |
| 26695/152 | Nairobi Block 149/3325 | 0.0225 |
| 26695/151 | Nairobi Block 149/3324 | 0.0225 |
| 26695/150 | Nairobi Block 149/3323 | 0.0345 |
| 26695/149 | Nairobi Block 149/3322 | 0.0424 |
| 26695/145 | Nairobi Block 149/3318 | 0.0232 |
| 26695/144 | Nairobi Block 149/3317 | 0.0332 |
| 26695/143 | Nairobi Block 149/3316 | 0.0225 |
| 26695/142 | Nairobi Block 149/3315 | 0.0225 |
| 26695/141 | Nairobi Block 149/3314 | 0.0246 |
| 26695/146 | Nairobi Block 149/3319 | 0.026 |
| 26695/147 | Nairobi Block 149/3320 | 0.0345 |
| 26695/148 | Nairobi Block 149/3321 | 0.0344 |
| 26695/133 | Nairobi Block 149/3306 | 0.0418 |
| 26695/134 | Nairobi Block 149/3307 | 0.0225 |
| 26695/132 | Nairobi Block 149/3305 | 0.0379 |
| 26695/131 | Nairobi Block 149/3304 | 0.0214 |
| 26695/130 | Nairobi Block 149/3303 | 0.0221 |
| 26695/129 | Nairobi Block 149/3302 | 0.0475 |
| 26695/128 | Nairobi Block 149/3301 | 0.0225 |
| 26695/127 | Nairobi Block 149/3300 | 0.0225 |
| 26695/126 | Nairobi Block 149/3299 | 0.0271 |
| 26695/140 | Nairobi Block 149/3313 | 0.027 |
| 26695/139 | Nairobi Block 149/3312 | 0.0225 |
| 26695/138 | Nairobi Block 149/3311 | 0.0225 |
| 26695/137 | Nairobi Block 149/3310 | 0.0225 |
| 26695/136 | Nairobi Block 149/3309 | 0.0225 |
| 26695/135 | Nairobi Block 149/3308 | 0.0225 |
| 26695/115 | Nairobi Block 149/3288 | 0.0223 |
| 26695/114 | Nairobi Block 149/3287 | 0.0225 |
| 26695/113 | Nairobi Block 149/3286 | 0.0225 |
| 26695/112 | Nairobi Block 149/3285 | 0.0225 |
| 26695/111 | Nairobi Block 149/3284 | 0.0225 |
| 26695/110 | Nairobi Block 149/3283 | 0.0214 |
| 26695/109 | Nairobi Block 149/3282 | 0.0451 |
| 26695/108 | Nairobi Block 149/3281 | 0.0225 |
| 26695/107 | Nairobi Block 149/3280 | 0.0225 |
| 26695/106 | Nairobi Block 149/3279 | 0.0225 |
| 26695/105 | Nairobi Block 149/3278 | 0.0225 |
| 26695/104 | Nairobi Block 149/3277 | 0.0225 |
| 26695/103 | Nairobi Block 149/3276 | 0.0225 |
| 26695/102 | Nairobi Block 149/3275 | 0.0225 |
| 26695/101 | Nairobi Block 149/3274 | 0.0225 |
| 26695/100 | Nairobi Block 149/3273 | 0.0225 |
| 26695/99 | Nairobi Block 149/3272 | 0.0365 |
| 26695/121 | Nairobi Block 149/3294 | 0.026 |
| 26695/120 | Nairobi Block 149/3293 | 0.0269 |
| 26695/119 | Nairobi Block 149/3292 | 0.0218 |
| 26695/118 | Nairobi Block 149/3291 | 0.0213 |
| 26695/117 | Nairobi Block 149/3290 | 0.0209 |
| 26695/116 | Nairobi Block 149/3289 | 0.0244 |
| 26695/125 | Nairobi Block 149/3298 | 0.026 |

| <i>Old L.R. No.</i> | <i>New Parcel No.</i> | <i>Area (Ha.)</i> |
|---------------------|------------------------|-------------------|
| 26695/124 | Nairobi Block 149/3297 | 0.0216 |
| 26695/123 | Nairobi Block 149/3296 | 0.0216 |
| 26695/122 | Nairobi Block 149/3295 | 0.0216 |
| 26695/186 | Nairobi Block 149/3359 | 0.0259 |
| 26695/185 | Nairobi Block 149/3358 | 0.0252 |
| 26695/184 | Nairobi Block 149/3357 | 0.0252 |
| 26695/183 | Nairobi Block 149/3356 | 0.0252 |
| 26695/182 | Nairobi Block 149/3355 | 0.0252 |
| 26695/181 | Nairobi Block 149/3354 | 0.0252 |
| 26695/180 | Nairobi Block 149/3353 | 0.0252 |
| 26695/179 | Nairobi Block 149/3352 | 0.0252 |
| 26695/178 | Nairobi Block 149/3351 | 0.0252 |
| 26695/177 | Nairobi Block 149/3350 | 0.0252 |
| 26695/176 | Nairobi Block 149/3349 | 0.0252 |
| 26695/175 | Nairobi Block 149/3348 | 0.0252 |
| 26695/174 | Nairobi Block 149/3347 | 0.0252 |
| 26695/173 | Nairobi Block 149/3346 | 0.0252 |
| 26695/172 | Nairobi Block 149/3345 | 0.0252 |
| 26695/171 | Nairobi Block 149/3344 | 0.0252 |
| 26695/170 | Nairobi Block 149/3343 | 0.0252 |
| 26695/169 | Nairobi Block 149/3342 | 0.0252 |
| 26695/168 | Nairobi Block 149/3341 | 0.0252 |
| 26695/167 | Nairobi Block 149/3340 | 0.0253 |
| 26695/50 | Nairobi Block 149/1696 | 0.0237 |
| 26695/49 | Nairobi Block 149/1695 | 0.0228 |
| 26695/48 | Nairobi Block 149/1694 | 0.022 |
| 26695/47 | Nairobi Block 149/1693 | 0.0211 |
| 26695/46 | Nairobi Block 149/1692 | 0.0202 |
| 26695/45 | Nairobi Block 149/1691 | 0.021 |
| 26695/44 | Nairobi Block 149/1690 | 0.0445 |
| 26695/43 | Nairobi Block 149/1689 | 0.1246 |
| 26695/42 | Nairobi Block 149/1688 | 0.0324 |
| 26695/41 | Nairobi Block 149/1687 | 0.0244 |
| 26695/40 | Nairobi Block 149/1686 | 0.0243 |
| 26695/39 | Nairobi Block 149/1685 | 0.0242 |
| 26695/38 | Nairobi Block 149/1684 | 0.0241 |
| 26695/37 | Nairobi Block 149/1683 | 0.024 |
| 26695/36 | Nairobi Block 149/1682 | 0.0293 |
| 26695/35 | Nairobi Block 149/1681 | 0.0292 |
| 26695/34 | Nairobi Block 149/1680 | 0.0237 |
| 26695/33 | Nairobi Block 149/1679 | 0.0236 |
| 26695/32 | Nairobi Block 149/1678 | 0.0234 |
| 26695/31 | Nairobi Block 149/1677 | 0.0233 |
| 26695/30 | Nairobi Block 149/1676 | 0.0232 |
| 26695/29 | Nairobi Block 149/1675 | 0.0231 |
| 26695/28 | Nairobi Block 149/1674 | 0.023 |
| 26695/27 | Nairobi Block 149/1673 | 0.0229 |
| 26695/26 | Nairobi Block 149/1672 | 0.0228 |
| 26695/25 | Nairobi Block 149/1671 | 0.0227 |
| 26695/24 | Nairobi Block 149/1670 | 0.0226 |
| 26695/23 | Nairobi Block 149/1669 | 0.0226 |
| 26695/22 | Nairobi Block 149/1668 | 0.0228 |
| 26695/21 | Nairobi Block 149/1667 | 0.0232 |
| 26695/20 | Nairobi Block 149/1666 | 0.0236 |
| 26695/19 | Nairobi Block 149/1665 | 0.0329 |
| 26695/54 | Nairobi Block 149/1700 | 0.0192 |
| 26695/53 | Nairobi Block 149/1699 | 0.0225 |
| 26695/52 | Nairobi Block 149/1698 | 0.0225 |
| 26695/51 | Nairobi Block 149/1697 | 0.0221 |
| 26695/59 | Nairobi Block 149/1705 | 0.036 |
| 26695/60 | Nairobi Block 149/1706 | 0.0279 |
| 26695/61 | Nairobi Block 149/1707 | 0.0279 |
| 26695/62 | Nairobi Block 149/1708 | 0.0279 |
| 26695/63 | Nairobi Block 149/1709 | 0.0279 |
| 26695/64 | Nairobi Block 149/1710 | 0.0279 |
| 26695/65 | Nairobi Block 149/1711 | 0.0279 |
| 26695/66 | Nairobi Block 149/1712 | 0.0279 |
| 26695/67 | Nairobi Block 149/1713 | 0.0291 |
| 26695/58 | Nairobi Block 149/1704 | 0.0221 |
| 26695/57 | Nairobi Block 149/1703 | 0.0225 |
| 26695/56 | Nairobi Block 149/1702 | 0.0225 |
| 26695/70 | Nairobi Block 149/1716 | 0.0225 |

| Old L.R. No. | New Parcel No. | Area (Ha.) |
|--------------|------------------------|------------|
| 26695/69 | Nairobi Block 149/1715 | 0.0225 |
| 26695/68 | Nairobi Block 149/1714 | 0.0221 |
| 26695/71 | Nairobi Block 149/1717 | 0.0298 |
| 26695/55 | Nairobi Block 149/1701 | 0.0253 |
| 26695/72 | Nairobi Block 149/1718 | 0.031 |
| 26695/95 | Nairobi Block 149/1741 | 0.0405 |
| 26695/96 | Nairobi Block 149/1742 | 0.0225 |
| 26695/97 | Nairobi Block 149/1743 | 0.0225 |
| 26695/73 | Nairobi Block 149/1719 | 0.0225 |
| 26695/74 | Nairobi Block 149/1720 | 0.0225 |
| 26695/75 | Nairobi Block 149/1721 | 0.0225 |
| 26695/76 | Nairobi Block 149/1722 | 0.0225 |
| 26695/77 | Nairobi Block 149/1723 | 0.0225 |
| 26695/78 | Nairobi Block 149/1724 | 0.0225 |
| 26695/98 | Nairobi Block 149/1735 | 0.0221 |
| 26695/80 | Nairobi Block 149/1726 | 0.036 |
| 26695/79 | Nairobi Block 149/1725 | 0.0371 |
| 26695/81 | Nairobi Block 149/1727 | 0.0279 |
| 26695/82 | Nairobi Block 149/1728 | 0.0279 |
| 26695/83 | Nairobi Block 149/1729 | 0.0279 |
| 26695/84 | Nairobi Block 149/1730 | 0.0279 |
| 26695/85 | Nairobi Block 149/1731 | 0.0279 |
| 26695/86 | Nairobi Block 149/1732 | 0.0279 |
| 26695/87 | Nairobi Block 149/1733 | 0.0497 |
| 26695/90 | Nairobi Block 149/1736 | 0.0221 |
| 26695/91 | Nairobi Block 149/1737 | 0.0225 |
| 26695/92 | Nairobi Block 149/1738 | 0.0225 |
| 26695/93 | Nairobi Block 149/1739 | 0.0225 |
| 26695/94 | Nairobi Block 149/1740 | 0.0241 |
| 26695/88 | Nairobi Block 149/1734 | 0.0244 |
| 27024/58 | Nairobi Block 149/3135 | 0.0279 |
| 27024/59 | Nairobi Block 149/3134 | 0.0279 |
| 27024/60 | Nairobi Block 149/3133 | 0.0279 |
| 27024/61 | Nairobi Block 149/3132 | 0.0279 |
| 27024/62 | Nairobi Block 149/3131 | 0.0279 |
| 27024/63 | Nairobi Block 149/3130 | 0.0279 |
| 27024/64 | Nairobi Block 149/3129 | 0.0279 |
| 27024/65 | Nairobi Block 149/3128 | 0.0279 |
| 27024/66 | Nairobi Block 149/3127 | 0.0279 |
| 27024/67 | Nairobi Block 149/3126 | 0.0279 |
| 27024/68 | Nairobi Block 149/3125 | 0.0279 |
| 27024/69 | Nairobi Block 149/3124 | 0.0386 |
| 27024/70 | Nairobi Block 149/3121 | 0.0347 |
| 27024/71 | Nairobi Block 149/3122 | 0.0314 |
| 27024/72 | Nairobi Block 149/3123 | 0.0388 |
| 27024/73 | Nairobi Block 149/3118 | 0.036 |
| 27024/74 | Nairobi Block 149/3119 | 0.028 |
| 27024/75 | Nairobi Block 149/3120 | 0.0401 |
| 27024/76 | Nairobi Block 149/3115 | 0.0459 |
| 27024/77 | Nairobi Block 149/3116 | 0.025 |
| 27024/78 | Nairobi Block 149/3117 | 0.0355 |
| 27024/79 | Nairobi Block 149/3114 | 0.036 |
| 27024/80 | Nairobi Block 149/3113 | 0.0276 |
| 27024/81 | Nairobi Block 149/3112 | 0.025 |
| 27024/82 | Nairobi Block 149/3111 | 0.029 |
| 27024/83 | Nairobi Block 149/3107 | 0.0431 |
| 27024/84 | Nairobi Block 149/3108 | 0.031 |
| 27024/85 | Nairobi Block 149/3109 | 0.031 |
| 27024/86 | Nairobi Block 149/3110 | 0.0381 |
| 27024/87 | Nairobi Block 149/3093 | 0.043 |
| 27024/88 | Nairobi Block 149/3094 | 0.0252 |
| 27024/89 | Nairobi Block 149/3095 | 0.0252 |
| 27024/90 | Nairobi Block 149/3096 | 0.0252 |
| 27024/91 | Nairobi Block 149/3097 | 0.0252 |
| 27024/92 | Nairobi Block 149/3098 | 0.0252 |
| 27024/93 | Nairobi Block 149/3099 | 0.0252 |
| 27024/94 | Nairobi Block 149/3100 | 0.0252 |
| 27024/95 | Nairobi Block 149/3101 | 0.0252 |
| 27024/96 | Nairobi Block 149/3102 | 0.0252 |
| 27024/97 | Nairobi Block 149/3103 | 0.0252 |
| 27024/98 | Nairobi Block 149/3104 | 0.0252 |
| 27024/99 | Nairobi Block 149/3105 | 0.0252 |

| Old L.R. No. | New Parcel No. | Area (Ha.) |
|--------------|------------------------|------------|
| 27024/100 | Nairobi Block 149/3106 | 0.1826 |
| 27024/2 | Nairobi Block 149/2971 | 0.046 |
| 27024/3 | Nairobi Block 149/2972 | 0.031 |
| 27024/4 | Nairobi Block 149/2973 | 0.031 |
| 27024/5 | Nairobi Block 149/2974 | 0.031 |
| 27024/6 | Nairobi Block 149/2975 | 0.031 |
| 27024/7 | Nairobi Block 149/2976 | 0.031 |
| 27024/8 | Nairobi Block 149/2977 | 0.031 |
| 27024/9 | Nairobi Block 149/2978 | 0.031 |
| 27024/10 | Nairobi Block 149/2979 | 0.031 |
| 27024/11 | Nairobi Block 149/2980 | 0.031 |
| 27024/12 | Nairobi Block 149/2981 | 0.031 |
| 27024/13 | Nairobi Block 149/2982 | 0.031 |
| 27024/14 | Nairobi Block 149/2983 | 0.031 |
| 27024/15 | Nairobi Block 149/2984 | 0.031 |
| 27024/16 | Nairobi Block 149/2985 | 0.031 |
| 27024/17 | Nairobi Block 149/2986 | 0.031 |
| 27024/18 | Nairobi Block 149/2987 | 0.031 |
| 27024/19 | Nairobi Block 149/2988 | 0.031 |
| 27024/20 | Nairobi Block 149/2989 | 0.031 |
| 27024/21 | Nairobi Block 149/2990 | 0.031 |
| 27024/22 | Nairobi Block 149/2991 | 0.031 |
| 27024/23 | Nairobi Block 149/2992 | 0.0306 |
| 27024/24 | Nairobi Block 149/2993 | 0.028 |
| 27024/25 | Nairobi Block 149/2994 | 0.0684 |
| 27024/26 | Nairobi Block 149/2995 | 0.0418 |
| 27024/27 | Nairobi Block 149/2996 | 0.0275 |
| 27024/28 | Nairobi Block 149/2997 | 0.0275 |
| 27024/29 | Nairobi Block 149/2998 | 0.0417 |
| 27024/30 | Nairobi Block 149/2999 | 0.04 |
| 27024/31 | Nairobi Block 149/3000 | 0.0377 |
| 27024/34 | Nairobi Block 149/3003 | 0.0311 |
| 27024/35 | Nairobi Block 149/3004 | 0.0314 |
| 27024/36 | Nairobi Block 149/3005 | 0.0341 |
| 27024/37 | Nairobi Block 149/3006 | 0.0403 |
| 27024/38 | Nairobi Block 149/3007 | 0.0279 |
| 27024/39 | Nairobi Block 149/3008 | 0.0279 |
| 27024/40 | Nairobi Block 149/3009 | 0.0279 |
| 27024/41 | Nairobi Block 149/3010 | 0.0279 |
| 27024/42 | Nairobi Block 149/3011 | 0.0279 |
| 27024/43 | Nairobi Block 149/3012 | 0.0279 |
| 27024/44 | Nairobi Block 149/3013 | 0.0279 |
| 27024/45 | Nairobi Block 149/3014 | 0.0279 |
| 27024/46 | Nairobi Block 149/3015 | 0.0279 |
| 27024/47 | Nairobi Block 149/3016 | 0.0279 |
| 27024/48 | Nairobi Block 149/3017 | 0.0279 |
| 27024/49 | Nairobi Block 149/3018 | 0.0279 |
| 27024/50 | Nairobi Block 149/3019 | 0.0279 |
| 27024/51 | Nairobi Block 149/3020 | 0.0279 |
| 27024/52 | Nairobi Block 149/3021 | 0.0279 |
| 27024/53 | Nairobi Block 149/3022 | 0.0279 |
| 27024/54 | Nairobi Block 149/3023 | 0.0279 |
| 27024/55 | Nairobi Block 149/3024 | 0.0279 |
| 27024/56 | Nairobi Block 149/3025 | 0.0279 |
| 27024/57 | Nairobi Block 149/3026 | 0.0279 |
| 27024/101 | Nairobi Block 149/3027 | 0.0252 |
| 27024/102 | Nairobi Block 149/3028 | 0.0252 |
| 27024/103 | Nairobi Block 149/3029 | 0.0252 |
| 27024/104 | Nairobi Block 149/3030 | 0.0252 |
| 27024/105 | Nairobi Block 149/3031 | 0.0252 |
| 27024/106 | Nairobi Block 149/3032 | 0.0252 |
| 27024/107 | Nairobi Block 149/3033 | 0.0252 |
| 27024/108 | Nairobi Block 149/3034 | 0.0252 |
| 27024/109 | Nairobi Block 149/3035 | 0.0252 |
| 27024/110 | Nairobi Block 149/3036 | 0.0252 |
| 27024/111 | Nairobi Block 149/3037 | 0.0252 |
| 27024/112 | Nairobi Block 149/3038 | 0.0252 |
| 27024/113 | Nairobi Block 149/3039 | 0.043 |
| 27024/114 | Nairobi Block 149/3040 | 0.0429 |
| 27024/115 | Nairobi Block 149/3041 | 0.031 |
| 27024/116 | Nairobi Block 149/3042 | 0.031 |
| 27024/117 | Nairobi Block 149/3043 | 0.031 |

| <i>Old L.R. No.</i> | <i>New Parcel No.</i> | <i>Area (Ha.)</i> |
|---------------------|------------------------|-------------------|
| 27024/118 | Nairobi Block 149/3044 | 0.031 |
| 27024/119 | Nairobi Block 149/3045 | 0.031 |
| 27024/120 | Nairobi Block 149/3046 | 0.0316 |
| 27024/121 | Nairobi Block 149/3047 | 0.0436 |
| 27024/122 | Nairobi Block 149/3048 | 0.031 |
| 27024/123 | Nairobi Block 149/3049 | 0.031 |
| 27024/124 | Nairobi Block 149/3050 | 0.031 |
| 27024/125 | Nairobi Block 149/3051 | 0.031 |
| 27024/126 | Nairobi Block 149/3052 | 0.031 |
| 27024/127 | Nairobi Block 149/3053 | 0.031 |
| 27024/128 | Nairobi Block 149/3054 | 0.031 |
| 27024/129 | Nairobi Block 149/3055 | 0.031 |
| 27024/130 | Nairobi Block 149/3056 | 0.031 |
| 27024/131 | Nairobi Block 149/3057 | 0.031 |
| 27024/132 | Nairobi Block 149/3058 | 0.031 |
| 27024/133 | Nairobi Block 149/3059 | 0.031 |
| 27024/134 | Nairobi Block 149/3060 | 0.031 |
| 27024/135 | Nairobi Block 149/3061 | 0.041 |
| 27024/136 | Nairobi Block 149/3062 | 0.041 |
| 27024/137 | Nairobi Block 149/3063 | 0.031 |
| 27024/138 | Nairobi Block 149/3064 | 0.031 |
| 27024/139 | Nairobi Block 149/3065 | 0.031 |
| 27024/140 | Nairobi Block 149/3066 | 0.031 |
| 27024/141 | Nairobi Block 149/3067 | 0.031 |
| 27024/142 | Nairobi Block 149/3068 | 0.031 |
| 27024/143 | Nairobi Block 149/3069 | 0.0478 |
| 27024/144 | Nairobi Block 149/3070 | 0.0374 |
| 27024/145 | Nairobi Block 149/3071 | 0.028 |
| 27024/146 | Nairobi Block 149/3072 | 0.028 |
| 27024/147 | Nairobi Block 149/3073 | 0.028 |
| 27024/148 | Nairobi Block 149/3074 | 0.028 |
| 27024/149 | Nairobi Block 149/3075 | 0.028 |
| 27024/150 | Nairobi Block 149/3076 | 0.028 |
| 27024/151 | Nairobi Block 149/3077 | 0.028 |
| 27024/152 | Nairobi Block 149/3078 | 0.028 |
| 27024/153 | Nairobi Block 149/3079 | 0.028 |
| 27024/154 | Nairobi Block 149/3080 | 0.0412 |
| 27024/155 | Nairobi Block 149/3081 | 0.0287 |
| 27024/156 | Nairobi Block 149/3082 | 0.0287 |
| 27024/157 | Nairobi Block 149/3083 | 0.0287 |
| 27024/158 | Nairobi Block 149/3084 | 0.0287 |
| 27024/159 | Nairobi Block 149/3085 | 0.0287 |
| 27024/160 | Nairobi Block 149/3086 | 0.0287 |
| 27024/161 | Nairobi Block 149/3087 | 0.0287 |
| 27024/162 | Nairobi Block 149/3088 | 0.0287 |
| 27024/163 | Nairobi Block 149/3089 | 0.0287 |
| 27024/165 | Nairobi Block 149/3091 | 0.0288 |
| 27024/166 | Nairobi Block 149/3092 | 0.0295 |
| 19952/31 | Nairobi Block 149/2149 | 0.0222 |
| 19952/30 | Nairobi Block 149/2148 | 0.0222 |
| 19952/29 | Nairobi Block 149/2147 | 0.0222 |
| 19952/28 | Nairobi Block 149/2146 | 0.0222 |
| 19952/27 | Nairobi Block 149/2145 | 0.0222 |
| 19952/26 | Nairobi Block 149/2144 | 0.0222 |
| 19952/25 | Nairobi Block 149/2143 | 0.0222 |
| 19952/24 | Nairobi Block 149/2142 | 0.0222 |
| 19952/23 | Nairobi Block 149/2141 | 0.0222 |
| 19952/22 | Nairobi Block 149/2140 | 0.0222 |
| 19952/21 | Nairobi Block 149/2139 | 0.0222 |
| 19952/20 | Nairobi Block 149/2138 | 0.0222 |
| 19952/19 | Nairobi Block 149/2137 | 0.0222 |
| 19952/18 | Nairobi Block 149/2136 | 0.0222 |
| 19952/17 | Nairobi Block 149/2135 | 0.0222 |
| 19952/16 | Nairobi Block 149/2134 | 0.0222 |
| 19952/15 | Nairobi Block 149/2133 | 0.0222 |
| 19952/14 | Nairobi Block 149/2132 | 0.0222 |
| 19952/13 | Nairobi Block 149/2131 | 0.0222 |
| 19952/11 | Nairobi Block 149/2129 | 0.0222 |
| 19952/10 | Nairobi Block 149/2128 | 0.0222 |
| 19952/9 | Nairobi Block 149/2127 | 0.0222 |
| 19952/8 | Nairobi Block 149/2126 | 0.0213 |
| 19952/7 | Nairobi Block 149/2125 | 0.0192 |

| <i>Old L.R. No.</i> | <i>New Parcel No.</i> | <i>Area (Ha.)</i> |
|---------------------|------------------------|-------------------|
| 19952/12 | Nairobi Block 149/2130 | 0.0239 |
| 19952/50 | Nairobi Block 149/2170 | 0.0293 |
| 19952/51 | Nairobi Block 149/2171 | 0.0247 |
| 19952/52 | Nairobi Block 149/2172 | 0.0191 |
| 19952/32 | Nairobi Block 149/2150 | 0.0202 |
| 19952/34 | Nairobi Block 149/2154 | 0.02 |
| 19952/33 | Nairobi Block 149/2151 | 0.0202 |
| 19952/35 | Nairobi Block 149/2155 | 0.02 |
| 19952/36 | Nairobi Block 149/2156 | 0.0203 |
| 19952/37 | Nairobi Block 149/2157 | 0.0193 |
| 19952/38 | Nairobi Block 149/2158 | 0.0202 |
| 19952/63 | Nairobi Block 149/2183 | 0.02 |
| 19952/39 | Nairobi Block 149/2159 | 0.0202 |
| 19952/62 | Nairobi Block 149/2182 | 0.02 |
| 19952/40 | Nairobi Block 149/2160 | 0.0202 |
| 19952/61 | Nairobi Block 149/2181 | 0.02 |
| 19952/41 | Nairobi Block 149/2161 | 0.0202 |
| 19952/60 | Nairobi Block 149/2180 | 0.02 |
| 19952/42 | Nairobi Block 149/2162 | 0.0202 |
| 19952/59 | Nairobi Block 149/2179 | 0.02 |
| 19952/43 | Nairobi Block 149/2163 | 0.0202 |
| 19952/58 | Nairobi Block 149/2178 | 0.02 |
| 19952/44 | Nairobi Block 149/2164 | 0.0202 |
| 19952/57 | Nairobi Block 149/2177 | 0.02 |
| 19952/45 | Nairobi Block 149/2165 | 0.0202 |
| 19952/56 | Nairobi Block 149/2176 | 0.02 |
| 19952/46 | Nairobi Block 149/2166 | 0.0202 |
| 19952/55 | Nairobi Block 149/2175 | 0.02 |
| 19952/47 | Nairobi Block 149/2167 | 0.0202 |
| 19952/54 | Nairobi Block 149/2174 | 0.02 |
| 19952/48 | Nairobi Block 149/2168 | 0.0202 |
| 19952/53 | Nairobi Block 149/2173 | 0.0165 |
| 19952/49 | Nairobi Block 149/2169 | 0.0329 |
| 19952/64 | Nairobi Block 149/2184 | 0.0193 |
| 19952/65 | Nairobi Block 149/2185 | 0.0203 |
| 19952/66 | Nairobi Block 149/2186 | 0.0203 |
| 19952/67 | Nairobi Block 149/2187 | 0.0203 |
| 19952/68 | Nairobi Block 149/2188 | 0.0203 |
| 19952/71 | Nairobi Block 149/2191 | 0.0268 |
| 19952/69 | Nairobi Block 149/2189 | 0.0203 |
| 19952/70 | Nairobi Block 149/2190 | 0.0195 |
| 19952/98 | Nairobi Block 149/2218 | 0.0541 |
| 19952/99 | Nairobi Block 149/2153 | 0.0233 |
| 19952/100 | Nairobi Block 149/2152 | 0.0275 |
| 19952/72 | Nairobi Block 149/2192 | 0.02 |
| 19952/73 | Nairobi Block 149/2193 | 0.02 |
| 19952/74 | Nairobi Block 149/2194 | 0.0282 |
| 19952/79 | Nairobi Block 149/2199 | 0.0236 |
| 19952/75 | Nairobi Block 149/2195 | 0.0276 |
| 19952/78 | Nairobi Block 149/2198 | 0.0246 |
| 19952/76 | Nairobi Block 149/2196 | 0.0278 |
| 19952/77 | Nairobi Block 149/2197 | 0.0519 |
| 19952/80 | Nairobi Block 149/2200 | 0.02 |
| 19952/91 | Nairobi Block 149/2211 | 0.02 |
| 19952/81 | Nairobi Block 149/2201 | 0.02 |
| 19952/90 | Nairobi Block 149/2210 | 0.02 |
| 19952/82 | Nairobi Block 149/2202 | 0.02 |
| 19952/89 | Nairobi Block 149/2209 | 0.02 |
| 19952/83 | Nairobi Block 149/2203 | 0.02 |
| 19952/88 | Nairobi Block 149/2208 | 0.02 |
| 19952/84 | Nairobi Block 149/2204 | 0.02 |
| 19952/87 | Nairobi Block 149/2207 | 0.0191 |
| 19952/86 | Nairobi Block 149/2206 | 0.0305 |
| 19952/85 | Nairobi Block 149/2205 | 0.0335 |
| 19952/92 | Nairobi Block 149/2212 | 0.02 |
| 19952/93 | Nairobi Block 149/2213 | 0.02 |
| 19952/94 | Nairobi Block 149/2214 | 0.02 |
| 19952/95 | Nairobi Block 149/2215 | 0.0191 |
| 19952/96 | Nairobi Block 149/2216 | 0.017 |
| 19952/97 | Nairobi Block 149/2217 | 0.032 |
| 19952/2 | Nairobi Block 149/3644 | 0.057 |
| 19952/101 | Nairobi Block 149/3663 | 0.0316 |

| Old L.R. No. | New Parcel No. | Area (Ha.) |
|--------------|------------------------|------------|
| 19952/102 | Nairobi Block 149/3664 | 0.0358 |
| 19952/103 | Nairobi Block 149/3665 | 0.0399 |
| 19952/105 | Nairobi Block 149/3667 | 0.02 |
| 19952/104 | Nairobi Block 149/3666 | 0.0241 |
| 19952/106 | Nairobi Block 149/3669 | 0.02 |
| 19952/107 | Nairobi Block 149/3668 | 0.017 |
| 19952/109 | Nairobi Block 149/3671 | 0.02 |
| 19952/108 | Nairobi Block 149/3670 | 0.02 |
| 19952/110 | Nairobi Block 149/3672 | 0.02 |
| 19952/111 | Nairobi Block 149/3673 | 0.02 |
| 19952/113 | Nairobi Block 149/3675 | 0.02 |
| 19952/112 | Nairobi Block 149/3674 | 0.02 |
| 19952/115 | Nairobi Block 149/3677 | 0.02 |
| 19952/114 | Nairobi Block 149/3676 | 0.02 |
| 19952/117 | Nairobi Block 149/3679 | 0.02 |
| 19952/116 | Nairobi Block 149/3678 | 0.02 |
| 19952/118 | Nairobi Block 149/3680 | 0.02 |
| 19952/119 | Nairobi Block 149/3681 | 0.02 |
| 19952/120 | Nairobi Block 149/3682 | 0.02 |
| 19952/121 | Nairobi Block 149/3683 | 0.02 |
| 19952/122 | Nairobi Block 149/3684 | 0.02 |
| 19952/123 | Nairobi Block 149/3685 | 0.02 |
| 19952/124 | Nairobi Block 149/3686 | 0.02 |
| 19952/125 | Nairobi Block 149/3687 | 0.02 |
| 19952/127 | Nairobi Block 149/3689 | 0.02 |
| 19952/126 | Nairobi Block 149/3688 | 0.02 |
| 19952/128 | Nairobi Block 149/3690 | 0.02 |
| 19952/129 | Nairobi Block 149/3691 | 0.02 |
| 19952/131 | Nairobi Block 149/3693 | 0.02 |
| 19952/130 | Nairobi Block 149/3692 | 0.02 |
| 19952/132 | Nairobi Block 149/3694 | 0.02 |
| 19952/133 | Nairobi Block 149/3695 | 0.02 |
| 19952/135 | Nairobi Block 149/3697 | 0.02 |
| 19952/134 | Nairobi Block 149/3696 | 0.02 |
| 19952/137 | Nairobi Block 149/3699 | 0.02 |
| 19952/136 | Nairobi Block 149/3698 | 0.02 |
| 19952/139 | Nairobi Block 149/3701 | 0.02 |
| 19952/138 | Nairobi Block 149/3700 | 0.02 |
| 19952/140 | Nairobi Block 149/3702 | 0.02 |
| 19952/143 | Nairobi Block 149/3705 | 0.02 |
| 19952/141 | Nairobi Block 149/3703 | 0.02 |
| 19952/142 | Nairobi Block 149/3704 | 0.02 |
| 19952/144 | Nairobi Block 149/3706 | 0.02 |
| 19952/147 | Nairobi Block 149/3709 | 0.02 |
| 19952/148 | Nairobi Block 149/3710 | 0.02 |
| 19952/145 | Nairobi Block 149/3707 | 0.02 |
| 19952/146 | Nairobi Block 149/3708 | 0.02 |
| 19952/149 | Nairobi Block 149/3711 | 0.02 |
| 19952/151 | Nairobi Block 149/3713 | 0.02 |
| 19952/152 | Nairobi Block 149/3714 | 0.02 |
| 19952/155 | Nairobi Block 149/3717 | 0.02 |
| 19952/156 | Nairobi Block 149/3718 | 0.02 |
| 19952/159 | Nairobi Block 149/3721 | 0.019 |
| 19952/150 | Nairobi Block 149/3712 | 0.02 |
| 19952/153 | Nairobi Block 149/3715 | 0.02 |
| 19952/154 | Nairobi Block 149/3716 | 0.02 |
| 19952/157 | Nairobi Block 149/3719 | 0.02 |
| 19952/158 | Nairobi Block 149/3720 | 0.019 |
| 19952/174 | Nairobi Block 149/3737 | 0.0278 |
| 19952/173 | Nairobi Block 149/3736 | 0.0173 |
| 19952/172 | Nairobi Block 149/3735 | 0.0215 |
| 19952/171 | Nairobi Block 149/3734 | 0.0256 |
| 19952/170 | Nairobi Block 149/3733 | 0.0279 |
| 19952/169 | Nairobi Block 149/3732 | 0.0283 |
| 19952/168 | Nairobi Block 149/3731 | 0.0287 |
| 19952/167 | Nairobi Block 149/3730 | 0.0291 |
| 19952/166 | Nairobi Block 149/3729 | 0.0295 |
| 19952/165 | Nairobi Block 149/3728 | 0.0299 |
| 19952/164 | Nairobi Block 149/3727 | 0.0302 |
| 19952/344 | Nairobi Block 149/3726 | 0.0306 |
| 19952/3 | Nairobi Block 149/3772 | 0.1061 |
| 19952/4 | Nairobi Block 149/3773 | 0.335 |

| Old L.R. No. | New Parcel No. | Area (Ha.) |
|--------------|------------------------|------------|
| 19952/5 | Nairobi Block 149/3774 | 0.8 |
| 19952/160 | Nairobi Block 149/3722 | 0.019 |
| 19952/163 | Nairobi Block 149/3725 | 0.02 |
| 19952/161 | Nairobi Block 149/3723 | 0.019 |
| 19952/162 | Nairobi Block 149/3724 | 0.02 |
| 19952/175 | Nairobi Block 149/3738 | 0.02 |
| 19952/176 | Nairobi Block 149/3739 | 0.02 |
| 19952/178 | Nairobi Block 149/3741 | 0.02 |
| 19952/177 | Nairobi Block 149/3740 | 0.02 |
| 19952/179 | Nairobi Block 149/3742 | 0.02 |
| 19952/180 | Nairobi Block 149/3743 | 0.02 |
| 19952/182 | Nairobi Block 149/3745 | 0.02 |
| 19952/181 | Nairobi Block 149/3744 | 0.02 |
| 19952/183 | Nairobi Block 149/3746 | 0.02 |
| 19952/184 | Nairobi Block 149/3747 | 0.02 |
| 19952/186 | Nairobi Block 149/3749 | 0.02 |
| 19952/185 | Nairobi Block 149/3748 | 0.02 |
| 19952/187 | Nairobi Block 149/3750 | 0.02 |
| 19952/188 | Nairobi Block 149/3751 | 0.02 |
| 19952/190 | Nairobi Block 149/3753 | 0.02 |
| 19952/189 | Nairobi Block 149/3752 | 0.02 |
| 19952/191 | Nairobi Block 149/3754 | 0.02 |
| 19952/192 | Nairobi Block 149/3755 | 0.02 |
| 19952/194 | Nairobi Block 149/3757 | 0.02 |
| 19952/195 | Nairobi Block 149/3758 | 0.02 |
| 19952/193 | Nairobi Block 149/3756 | 0.02 |
| 19952/196 | Nairobi Block 149/3759 | 0.02 |
| 19952/198 | Nairobi Block 149/3761 | 0.02 |
| 19952/199 | Nairobi Block 149/3762 | 0.02 |
| 19952/202 | Nairobi Block 149/3765 | 0.02 |
| 19952/203 | Nairobi Block 149/3766 | 0.02 |
| 19952/206 | Nairobi Block 149/3769 | 0.02 |
| 19952/208 | Nairobi Block 149/3771 | 0.0342 |
| 19952/197 | Nairobi Block 149/3760 | 0.02 |
| 19952/200 | Nairobi Block 149/3763 | 0.02 |
| 19952/201 | Nairobi Block 149/3764 | 0.02 |
| 19952/204 | Nairobi Block 149/3767 | 0.02 |
| 19952/205 | Nairobi Block 149/3768 | 0.02 |
| 19952/207 | Nairobi Block 149/3770 | 0.0449 |
| 19952/209 | Nairobi Block 149/1466 | 0.018 |
| 19952/210 | Nairobi Block 149/1467 | 0.02 |
| 19952/211 | Nairobi Block 149/1468 | 0.02 |
| 19952/212 | Nairobi Block 149/2219 | 0.02 |
| 19952/213 | Nairobi Block 149/2220 | 0.02 |
| 19952/214 | Nairobi Block 149/2221 | 0.02 |
| 19952/215 | Nairobi Block 149/2222 | 0.02 |
| 19952/216 | Nairobi Block 149/2223 | 0.0289 |
| 19952/217 | Nairobi Block 149/2224 | 0.0298 |
| 19952/218 | Nairobi Block 149/2225 | 0.0277 |
| 19952/219 | Nairobi Block 149/2226 | 0.033 |
| 19952/220 | Nairobi Block 149/2227 | 0.0579 |
| 19952/222 | Nairobi Block 149/2229 | 0.0192 |
| 19952/221 | Nairobi Block 149/2228 | 0.0192 |
| 19952/223 | Nairobi Block 149/2230 | 0.0192 |
| 19952/224 | Nairobi Block 149/2231 | 0.0192 |
| 19952/226 | Nairobi Block 149/2232 | 0.0192 |
| 19952/225 | Nairobi Block 149/2233 | 0.0192 |
| 19952/227 | Nairobi Block 149/2234 | 0.0192 |
| 19952/228 | Nairobi Block 149/2235 | 0.0192 |
| 19952/230 | Nairobi Block 149/2237 | 0.0192 |
| 19952/229 | Nairobi Block 149/2236 | 0.0192 |
| 19952/231 | Nairobi Block 149/2238 | 0.0192 |
| 19952/232 | Nairobi Block 149/2239 | 0.0192 |
| 19952/234 | Nairobi Block 149/2241 | 0.0192 |
| 19952/233 | Nairobi Block 149/2240 | 0.0192 |
| 19952/235 | Nairobi Block 149/2242 | 0.0172 |
| 19952/236 | Nairobi Block 149/2243 | 0.0172 |
| 19952/252 | Nairobi Block 149/2258 | 0.0196 |
| 19952/253 | Nairobi Block 149/2259 | 0.0201 |
| 19952/251 | Nairobi Block 149/2257 | 0.023 |
| 19952/248 | Nairobi Block 149/2255 | 0.023 |
| 19952/245 | Nairobi Block 149/2252 | 0.0221 |

| Old L.R. No. | New Parcel No. | Area (Ha.) |
|--------------|------------------------|------------|
| 19952/250 | Nairobi Block 149/3609 | 0.0189 |
| 19952/249 | Nairobi Block 149/2256 | 0.0241 |
| 19952/244 | Nairobi Block 149/2251 | 0.0221 |
| 19952/241 | Nairobi Block 149/2248 | 0.023 |
| 19952/240 | Nairobi Block 149/2247 | 0.023 |
| 19952/237 | Nairobi Block 149/2244 | 0.028 |
| 19952/254 | Nairobi Block 149/2260 | 0.0606 |
| 19952/270 | Nairobi Block 149/1981 | 0.0552 |
| 19952/271 | Nairobi Block 149/1982 | 0.0445 |
| 19952/272 | Nairobi Block 149/1983 | 0.043 |
| 19952/269 | Nairobi Block 149/1980 | 0.0222 |
| 19952/268 | Nairobi Block 149/1979 | 0.0222 |
| 19952/267 | Nairobi Block 149/1978 | 0.0222 |
| 19952/266 | Nairobi Block 149/1977 | 0.0222 |
| 19952/265 | Nairobi Block 149/1976 | 0.0222 |
| 19952/264 | Nairobi Block 149/1975 | 0.0222 |
| 19952/263 | Nairobi Block 149/1974 | 0.0222 |
| 19952/262 | Nairobi Block 149/1973 | 0.0222 |
| 19952/261 | Nairobi Block 149/1972 | 0.0222 |
| 19952/260 | Nairobi Block 149/1971 | 0.0222 |
| 19952/259 | Nairobi Block 149/1970 | 0.0222 |
| 19952/258 | Nairobi Block 149/1969 | 0.0222 |
| 19952/257 | Nairobi Block 149/1968 | 0.0222 |
| 19952/256 | Nairobi Block 149/1967 | 0.0222 |
| 19952/275 | Nairobi Block 149/1986 | 0.0202 |
| 19952/274 | Nairobi Block 149/1985 | 0.02 |
| 19952/276 | Nairobi Block 149/1987 | 0.0202 |
| 19952/277 | Nairobi Block 149/1988 | 0.02 |
| 19952/282 | Nairobi Block 149/1993 | 0.0202 |
| 19952/281 | Nairobi Block 149/1992 | 0.02 |
| 19952/283 | Nairobi Block 149/1994 | 0.0202 |
| 19952/284 | Nairobi Block 149/1995 | 0.02 |
| 19952/273 | Nairobi Block 149/1984 | 0.0308 |
| 19952/278 | Nairobi Block 149/1989 | 0.0194 |
| 19952/280 | Nairobi Block 149/1991 | 0.0198 |
| 19952/279 | Nairobi Block 149/1990 | 0.0198 |
| 19952/287 | Nairobi Block 149/1998 | 0.0198 |
| 19952/288 | Nairobi Block 149/1999 | 0.0198 |
| 19952/289 | Nairobi Block 149/2000 | 0.0203 |
| 19952/298 | Nairobi Block 149/2009 | 0.0203 |
| 19952/299 | Nairobi Block 149/2010 | 0.0203 |
| 19952/300 | Nairobi Block 149/2011 | 0.0203 |
| 19952/305 | Nairobi Block 149/2016 | 0.0203 |
| 19952/306 | Nairobi Block 149/2017 | 0.0203 |
| 19952/311 | Nairobi Block 149/2022 | 0.0203 |
| 19952/312 | Nairobi Block 149/2023 | 0.0203 |
| 19952/315 | Nairobi Block 149/2026 | 0.0424 |
| 19952/415 | Nairobi Block 149/2124 | 0.1154 |
| 19952/285 | Nairobi Block 149/1996 | 0.0202 |
| 19952/286 | Nairobi Block 149/1997 | 0.02 |
| 19952/291 | Nairobi Block 149/2002 | 0.0202 |
| 19952/290 | Nairobi Block 149/2001 | 0.02 |
| 19952/292 | Nairobi Block 149/2003 | 0.0202 |
| 19952/293 | Nairobi Block 149/2004 | 0.02 |
| 19952/295 | Nairobi Block 149/2006 | 0.0202 |
| 19952/294 | Nairobi Block 149/2005 | 0.02 |
| 19952/296 | Nairobi Block 149/2007 | 0.0202 |
| 19952/297 | Nairobi Block 149/2008 | 0.02 |
| 19952/302 | Nairobi Block 149/2013 | 0.0202 |
| 19952/301 | Nairobi Block 149/2012 | 0.02 |
| 19952/303 | Nairobi Block 149/2014 | 0.0202 |
| 19952/304 | Nairobi Block 149/2015 | 0.02 |
| 19952/308 | Nairobi Block 149/2019 | 0.0202 |
| 19952/307 | Nairobi Block 149/2018 | 0.02 |
| 19952/309 | Nairobi Block 149/2020 | 0.0202 |
| 19952/310 | Nairobi Block 149/2021 | 0.02 |
| 19952/314 | Nairobi Block 149/2025 | 0.0202 |
| 19952/313 | Nairobi Block 149/2024 | 0.02 |
| 19952/320 | Nairobi Block 149/2031 | 0.0321 |
| 19952/321 | Nairobi Block 149/2032 | 0.02 |
| 19952/322 | Nairobi Block 149/2033 | 0.02 |
| 19952/323 | Nairobi Block 149/2034 | 0.02 |

| Old L.R. No. | New Parcel No. | Area (Ha.) |
|--------------|------------------------|------------|
| 19952/324 | Nairobi Block 149/2035 | 0.02 |
| 19952/325 | Nairobi Block 149/2036 | 0.02 |
| 19952/326 | Nairobi Block 149/2037 | 0.02 |
| 19952/327 | Nairobi Block 149/2038 | 0.02 |
| 19952/328 | Nairobi Block 149/2039 | 0.02 |
| 19952/329 | Nairobi Block 149/2040 | 0.017 |
| 19952/330 | Nairobi Block 149/2041 | 0.0301 |
| 19952/318 | Nairobi Block 149/2029 | 0.0287 |
| 19952/319 | Nairobi Block 149/2030 | 0.024 |
| 19952/317 | Nairobi Block 149/2028 | 0.0224 |
| 19952/316 | Nairobi Block 149/2027 | 0.0249 |
| 19952/337 | Nairobi Block 149/2048 | 0.019 |
| 19952/336 | Nairobi Block 149/2047 | 0.02 |
| 19952/335 | Nairobi Block 149/2046 | 0.02 |
| 19952/334 | Nairobi Block 149/2045 | 0.02 |
| 19952/333 | Nairobi Block 149/2044 | 0.02 |
| 19952/332 | Nairobi Block 149/2043 | 0.02 |
| 19952/331 | Nairobi Block 149/2042 | 0.02 |
| 19952/338 | Nairobi Block 149/2049 | 0.019 |
| 19952/339 | Nairobi Block 149/2050 | 0.02 |
| 19952/340 | Nairobi Block 149/2051 | 0.02 |
| 19952/341 | Nairobi Block 149/2052 | 0.02 |
| 19952/342 | Nairobi Block 149/2053 | 0.02 |
| 19952/343 | Nairobi Block 149/2054 | 0.02 |
| 19952/346 | Nairobi Block 149/2055 | 0.02 |
| 19952/353 | Nairobi Block 149/2062 | 0.019 |
| 19952/352 | Nairobi Block 149/2061 | 0.02 |
| 19952/351 | Nairobi Block 149/2060 | 0.02 |
| 19952/350 | Nairobi Block 149/2059 | 0.02 |
| 19952/349 | Nairobi Block 149/2058 | 0.02 |
| 19952/348 | Nairobi Block 149/2057 | 0.02 |
| 19952/347 | Nairobi Block 149/2056 | 0.017 |
| 19952/354 | Nairobi Block 149/2063 | 0.02 |
| 19952/355 | Nairobi Block 149/2064 | 0.02 |
| 19952/359 | Nairobi Block 149/2068 | 0.02 |
| 19952/358 | Nairobi Block 149/2067 | 0.02 |
| 19952/360 | Nairobi Block 149/2069 | 0.02 |
| 19952/361 | Nairobi Block 149/2070 | 0.02 |
| 19952/365 | Nairobi Block 149/2074 | 0.02 |
| 19952/364 | Nairobi Block 149/2073 | 0.02 |
| 19952/366 | Nairobi Block 149/2075 | 0.02 |
| 19952/367 | Nairobi Block 149/2076 | 0.02 |
| 19952/371 | Nairobi Block 149/2080 | 0.02 |
| 19952/370 | Nairobi Block 149/2079 | 0.02 |
| 19952/372 | Nairobi Block 149/2081 | 0.02 |
| 19952/373 | Nairobi Block 149/2082 | 0.02 |
| 19952/356 | Nairobi Block 149/2065 | 0.018 |
| 19952/357 | Nairobi Block 149/2066 | 0.0201 |
| 19952/362 | Nairobi Block 149/2071 | 0.0201 |
| 19952/363 | Nairobi Block 149/2072 | 0.0201 |
| 19952/368 | Nairobi Block 149/2077 | 0.0201 |
| 19952/369 | Nairobi Block 149/2078 | 0.0201 |
| 19952/374 | Nairobi Block 149/2083 | 0.0201 |
| 19952/375 | Nairobi Block 149/2084 | 0.0201 |
| 19952/395 | Nairobi Block 149/2104 | 0.024 |
| 19952/396 | Nairobi Block 149/2105 | 0.025 |
| 19952/394 | Nairobi Block 149/2103 | 0.02 |
| 19952/393 | Nairobi Block 149/2102 | 0.02 |
| 19952/392 | Nairobi Block 149/2101 | 0.02 |
| 19952/391 | Nairobi Block 149/2100 | 0.02 |
| 19952/390 | Nairobi Block 149/2099 | 0.02 |
| 19952/389 | Nairobi Block 149/2098 | 0.02 |
| 19952/388 | Nairobi Block 149/2097 | 0.02 |
| 19952/387 | Nairobi Block 149/2096 | 0.02 |
| 19952/386 | Nairobi Block 149/2095 | 0.02 |
| 19952/385 | Nairobi Block 149/2094 | 0.02 |
| 19952/384 | Nairobi Block 149/2093 | 0.02 |
| 19952/383 | Nairobi Block 149/2092 | 0.02 |
| 19952/382 | Nairobi Block 149/2091 | 0.02 |
| 19952/381 | Nairobi Block 149/2090 | 0.02 |
| 19952/380 | Nairobi Block 149/2089 | 0.02 |
| 19952/379 | Nairobi Block 149/2088 | 0.02 |

| Old L.R. No. | New Parcel No. | Area (Ha.) |
|--------------|------------------------|------------|
| 19952/378 | Nairobi Block 149/2087 | 0.02 |
| 19952/377 | Nairobi Block 149/2086 | 0.02 |
| 19952/376 | Nairobi Block 149/2085 | 0.02 |
| 19952/397 | Nairobi Block 149/2106 | 0.017 |
| 19952/398 | Nairobi Block 149/2107 | 0.0191 |
| 19952/399 | Nairobi Block 149/2108 | 0.02 |
| 19952/400 | Nairobi Block 149/2109 | 0.019 |
| 19952/401 | Nairobi Block 149/2110 | 0.019 |
| 19952/402 | Nairobi Block 149/2111 | 0.02 |
| 19952/403 | Nairobi Block 149/2112 | 0.02 |
| 19952/404 | Nairobi Block 149/2113 | 0.02 |
| 19952/405 | Nairobi Block 149/2114 | 0.02 |
| 19952/406 | Nairobi Block 149/2115 | 0.02 |
| 19952/407 | Nairobi Block 149/2116 | 0.02 |
| 19952/408 | Nairobi Block 149/2117 | 0.02 |
| 19952/409 | Nairobi Block 149/2118 | 0.02 |
| 19952/410 | Nairobi Block 149/2119 | 0.02 |
| 19952/411 | Nairobi Block 149/2120 | 0.02 |
| 19952/412 | Nairobi Block 149/2121 | 0.02 |
| 19952/413 | Nairobi Block 149/2122 | 0.02 |
| 19952/414 | Nairobi Block 149/2123 | 0.019 |
| 19952/619 | Nairobi Block 149/3195 | 0.029 |
| 19952/620 | Nairobi Block 149/3196 | 0.032 |
| 19952/621 | Nairobi Block 149/3197 | 0.025 |
| 19952/670 | Nairobi Block 149/3246 | 0.024 |
| 19952/671 | Nairobi Block 149/3247 | 0.024 |
| 19952/745 | Nairobi Block 149/3170 | 0.025 |
| 19952/618 | Nairobi Block 149/3194 | 0.017 |
| 19952/617 | Nairobi Block 149/3193 | 0.0191 |
| 19952/616 | Nairobi Block 149/3192 | 0.02 |
| 19952/615 | Nairobi Block 149/3191 | 0.02 |
| 19952/623 | Nairobi Block 149/3199 | 0.017 |
| 19952/624 | Nairobi Block 149/3200 | 0.0191 |
| 19952/629 | Nairobi Block 149/3205 | 0.0195 |
| 19952/628 | Nairobi Block 149/3204 | 0.0195 |
| 19952/622 | Nairobi Block 149/3198 | 0.02 |
| 19952/625 | Nairobi Block 149/3201 | 0.02 |
| 19952/627 | Nairobi Block 149/3203 | 0.0195 |
| 19952/626 | Nairobi Block 149/3202 | 0.0195 |
| 19952/673 | Nairobi Block 149/3249 | 0.017 |
| 19952/672 | Nairobi Block 149/3248 | 0.017 |
| 19952/674 | Nairobi Block 149/3250 | 0.0191 |
| 19952/675 | Nairobi Block 149/3251 | 0.0191 |
| 19952/752 | Nairobi Block 149/3252 | 0.02 |
| 19952/676 | Nairobi Block 149/3253 | 0.02 |
| 19952/677 | Nairobi Block 149/3254 | 0.02 |
| 19952/678 | Nairobi Block 149/3255 | 0.02 |
| 19952/600 | Nairobi Block 149/3176 | 0.02 |
| 19952/599 | Nairobi Block 149/3175 | 0.02 |
| 19952/598 | Nairobi Block 149/3174 | 0.02 |
| 19952/597 | Nairobi Block 149/3173 | 0.0191 |
| 19952/596 | Nairobi Block 149/3172 | 0.017 |
| 19952/595 | Nairobi Block 149/3171 | 0.0245 |
| 19952/644 | Nairobi Block 149/3221 | 0.0195 |
| 19952/645 | Nairobi Block 149/3220 | 0.0195 |
| 19952/646 | Nairobi Block 149/3222 | 0.02 |
| 19952/647 | Nairobi Block 149/3223 | 0.0191 |
| 19952/648 | Nairobi Block 149/3224 | 0.0215 |
| 19952/649 | Nairobi Block 149/3225 | 0.019 |
| 19952/655 | Nairobi Block 149/3231 | 0.0195 |
| 19952/654 | Nairobi Block 149/3230 | 0.0195 |
| 19952/653 | Nairobi Block 149/3229 | 0.02 |
| 19952/652 | Nairobi Block 149/3228 | 0.0191 |
| 19952/650 | Nairobi Block 149/3226 | 0.019 |
| 19952/651 | Nairobi Block 149/3227 | 0.0215 |
| 19952/708 | Nairobi Block 149/3572 | 0.02 |
| 19952/707 | Nairobi Block 149/3571 | 0.02 |
| 19952/709 | Nairobi Block 149/3573 | 0.02 |
| 19952/710 | Nairobi Block 149/3574 | 0.02 |
| 19952/712 | Nairobi Block 149/3576 | 0.02 |
| 19952/711 | Nairobi Block 149/3575 | 0.02 |
| 19952/713 | Nairobi Block 149/3577 | 0.0191 |

| Old L.R. No. | New Parcel No. | Area (Ha.) |
|--------------|------------------------|------------|
| 19952/714 | Nairobi Block 149/3578 | 0.0191 |
| 19952/716 | Nairobi Block 149/3580 | 0.0171 |
| 19952/715 | Nairobi Block 149/3579 | 0.0171 |
| 19952/717 | Nairobi Block 149/3581 | 0.0245 |
| 19952/718 | Nairobi Block 149/3582 | 0.0245 |
| 19952/614 | Nairobi Block 149/3190 | 0.02 |
| 19952/613 | Nairobi Block 149/3189 | 0.02 |
| 19952/612 | Nairobi Block 149/3188 | 0.02 |
| 19952/611 | Nairobi Block 149/3187 | 0.02 |
| 19952/610 | Nairobi Block 149/3186 | 0.02 |
| 19952/609 | Nairobi Block 149/3185 | 0.02 |
| 19952/608 | Nairobi Block 149/3184 | 0.02 |
| 19952/607 | Nairobi Block 149/3183 | 0.02 |
| 19952/606 | Nairobi Block 149/3182 | 0.02 |
| 19952/605 | Nairobi Block 149/3181 | 0.02 |
| 19952/604 | Nairobi Block 149/3180 | 0.02 |
| 19952/603 | Nairobi Block 149/3179 | 0.02 |
| 19952/602 | Nairobi Block 149/3178 | 0.02 |
| 19952/601 | Nairobi Block 149/3177 | 0.02 |
| 19952/631 | Nairobi Block 149/3207 | 0.0195 |
| 19952/630 | Nairobi Block 149/3206 | 0.0195 |
| 19952/632 | Nairobi Block 149/3208 | 0.02 |
| 19952/633 | Nairobi Block 149/3209 | 0.02 |
| 19952/634 | Nairobi Block 149/3210 | 0.02 |
| 19952/635 | Nairobi Block 149/3211 | 0.02 |
| 19952/636 | Nairobi Block 149/3212 | 0.02 |
| 19952/637 | Nairobi Block 149/3213 | 0.02 |
| 19952/638 | Nairobi Block 149/3214 | 0.02 |
| 19952/639 | Nairobi Block 149/3215 | 0.02 |
| 19952/640 | Nairobi Block 149/3216 | 0.02 |
| 19952/641 | Nairobi Block 149/3217 | 0.02 |
| 19952/643 | Nairobi Block 149/3219 | 0.0195 |
| 19952/642 | Nairobi Block 149/3218 | 0.0195 |
| 19952/669 | Nairobi Block 149/3245 | 0.0195 |
| 19952/668 | Nairobi Block 149/3244 | 0.0195 |
| 19952/667 | Nairobi Block 149/3243 | 0.02 |
| 19952/666 | Nairobi Block 149/3242 | 0.02 |
| 19952/665 | Nairobi Block 149/3241 | 0.02 |
| 19952/664 | Nairobi Block 149/3240 | 0.02 |
| 19952/663 | Nairobi Block 149/3239 | 0.02 |
| 19952/662 | Nairobi Block 149/3238 | 0.02 |
| 19952/661 | Nairobi Block 149/3237 | 0.02 |
| 19952/660 | Nairobi Block 149/3236 | 0.02 |
| 19952/659 | Nairobi Block 149/3235 | 0.02 |
| 19952/658 | Nairobi Block 149/3234 | 0.02 |
| 19952/657 | Nairobi Block 149/3233 | 0.0195 |
| 19952/656 | Nairobi Block 149/3232 | 0.0195 |
| 19952/744 | Nairobi Block 149/3366 | 0.02 |
| 19952/743 | Nairobi Block 149/3367 | 0.02 |
| 19952/742 | Nairobi Block 149/3606 | 0.02 |
| 19952/741 | Nairobi Block 149/3605 | 0.02 |
| 19952/740 | Nairobi Block 149/3604 | 0.02 |
| 19952/739 | Nairobi Block 149/3603 | 0.02 |
| 19952/738 | Nairobi Block 149/3602 | 0.02 |
| 19952/737 | Nairobi Block 149/3601 | 0.02 |
| 19952/736 | Nairobi Block 149/3608 | 0.02 |
| 19952/735 | Nairobi Block 149/3599 | 0.02 |
| 19952/734 | Nairobi Block 149/3598 | 0.02 |
| 19952/733 | Nairobi Block 149/3597 | 0.02 |
| 19952/732 | Nairobi Block 149/3596 | 0.02 |
| 19952/731 | Nairobi Block 149/3595 | 0.02 |
| 19952/730 | Nairobi Block 149/3594 | 0.02 |
| 19952/729 | Nairobi Block 149/3593 | 0.02 |
| 19952/728 | Nairobi Block 149/3592 | 0.02 |
| 19952/727 | Nairobi Block 149/3591 | 0.02 |
| 19952/726 | Nairobi Block 149/3590 | 0.02 |
| 19952/725 | Nairobi Block 149/3589 | 0.02 |
| 19952/724 | Nairobi Block 149/3588 | 0.02 |
| 19952/723 | Nairobi Block 149/3587 | 0.02 |
| 19952/722 | Nairobi Block 149/3586 | 0.02 |
| 19952/721 | Nairobi Block 149/3585 | 0.0191 |
| 19952/720 | Nairobi Block 149/3584 | 0.0171 |

| Old L.R. No. | New Parcel No. | Area (Ha.) |
|--------------|------------------------|------------|
| 19952/719 | Nairobi Block 149/3583 | 0.0245 |
| 19952/680 | Nairobi Block 149/3257 | 0.02 |
| 19952/679 | Nairobi Block 149/3256 | 0.02 |
| 19952/681 | Nairobi Block 149/3258 | 0.02 |
| 19952/682 | Nairobi Block 149/3259 | 0.02 |
| 19952/684 | Nairobi Block 149/3261 | 0.02 |
| 19952/683 | Nairobi Block 149/3260 | 0.02 |
| 19952/685 | Nairobi Block 149/3262 | 0.02 |
| 19952/686 | Nairobi Block 149/3263 | 0.02 |
| 19952/688 | Nairobi Block 149/3265 | 0.02 |
| 19952/687 | Nairobi Block 149/3264 | 0.02 |
| 19952/689 | Nairobi Block 149/3266 | 0.02 |
| 19952/690 | Nairobi Block 149/3267 | 0.02 |
| 19952/692 | Nairobi Block 149/3269 | 0.02 |
| 19952/691 | Nairobi Block 149/3268 | 0.02 |
| 19952/693 | Nairobi Block 149/3270 | 0.02 |
| 19952/694 | Nairobi Block 149/3271 | 0.02 |
| 19952/696 | Nairobi Block 149/3376 | 0.02 |
| 19952/695 | Nairobi Block 149/2249 | 0.02 |
| 19952/697 | Nairobi Block 149/2250 | 0.02 |
| 19952/698 | Nairobi Block 149/2253 | 0.02 |
| 19952/700 | Nairobi Block 149/2254 | 0.02 |
| 19952/699 | Nairobi Block 149/3377 | 0.02 |
| 19952/701 | Nairobi Block 149/2245 | 0.02 |
| 19952/702 | Nairobi Block 149/3146 | 0.02 |
| 19952/704 | Nairobi Block 149/3140 | 0.02 |
| 19952/703 | Nairobi Block 149/3145 | 0.02 |
| 19952/705 | Nairobi Block 149/3148 | 0.02 |
| 19952/706 | Nairobi Block 149/3144 | 0.02 |
| 19952/442 | Nairobi Block 149/3412 | 0.025 |
| 19952/443 | Nairobi Block 149/3413 | 0.024 |
| 19952/441 | Nairobi Block 149/3411 | 0.02 |
| 19952/440 | Nairobi Block 149/3410 | 0.02 |
| 19952/439 | Nairobi Block 149/3409 | 0.02 |
| 19952/438 | Nairobi Block 149/3408 | 0.02 |
| 19952/437 | Nairobi Block 149/3407 | 0.02 |
| 19952/436 | Nairobi Block 149/3406 | 0.02 |
| 19952/435 | Nairobi Block 149/3405 | 0.02 |
| 19952/434 | Nairobi Block 149/3404 | 0.02 |
| 19952/433 | Nairobi Block 149/3403 | 0.02 |
| 19952/432 | Nairobi Block 149/3402 | 0.02 |
| 19952/431 | Nairobi Block 149/3401 | 0.02 |
| 19952/430 | Nairobi Block 149/3400 | 0.02 |
| 19952/428 | Nairobi Block 149/3398 | 0.02 |
| 19952/427 | Nairobi Block 149/3397 | 0.02 |
| 19952/426 | Nairobi Block 149/3396 | 0.02 |
| 19952/425 | Nairobi Block 149/3395 | 0.02 |
| 19952/424 | Nairobi Block 149/3394 | 0.02 |
| 19952/423 | Nairobi Block 149/3393 | 0.02 |
| 19952/422 | Nairobi Block 149/3392 | 0.02 |
| 19952/421 | Nairobi Block 149/3391 | 0.02 |
| 19952/420 | Nairobi Block 149/3390 | 0.02 |
| 19952/419 | Nairobi Block 149/3389 | 0.02 |
| 19952/418 | Nairobi Block 149/3388 | 0.0191 |
| 19952/417 | Nairobi Block 149/3387 | 0.017 |
| 19952/416 | Nairobi Block 149/3386 | 0.025 |
| 19952/446 | Nairobi Block 149/3416 | 0.017 |
| 19952/445 | Nairobi Block 149/3415 | 0.017 |
| 19952/447 | Nairobi Block 149/3417 | 0.0191 |
| 19952/448 | Nairobi Block 149/3418 | 0.0191 |
| 19952/450 | Nairobi Block 149/3420 | 0.02 |
| 19952/449 | Nairobi Block 149/3419 | 0.02 |
| 19952/451 | Nairobi Block 149/3421 | 0.019 |
| 19952/452 | Nairobi Block 149/3422 | 0.019 |
| 19952/444 | Nairobi Block 149/3414 | 0.024 |
| 19952/516 | Nairobi Block 149/3487 | 0.0214 |
| 19952/515 | Nairobi Block 149/3486 | 0.02 |
| 19952/514 | Nairobi Block 149/3485 | 0.02 |
| 19952/513 | Nairobi Block 149/3483 | 0.0185 |
| 19952/512 | Nairobi Block 149/3482 | 0.0185 |
| 19952/517 | Nairobi Block 149/3488 | 0.0214 |
| 19952/518 | Nairobi Block 149/3489 | 0.0205 |

| Old L.R. No. | New Parcel No. | Area (Ha.) |
|--------------|------------------------|------------|
| 19952/519 | Nairobi Block 149/3490 | 0.0205 |
| 19952/521 | Nairobi Block 149/3492 | 0.019 |
| 19952/520 | Nairobi Block 149/3491 | 0.019 |
| 19952/594 | Nairobi Block 149/3566 | 0.025 |
| 19952/593 | Nairobi Block 149/3565 | 0.02 |
| 19952/591 | Nairobi Block 149/3563 | 0.0175 |
| 19952/592 | Nairobi Block 149/3564 | 0.02 |
| 19952/590 | Nairobi Block 149/3562 | 0.0196 |
| 19952/589 | Nairobi Block 149/3561 | 0.02 |
| 19952/587 | Nairobi Block 149/3559 | 0.0205 |
| 19952/588 | Nairobi Block 149/3560 | 0.02 |
| 19952/586 | Nairobi Block 149/3558 | 0.0195 |
| 19952/585 | Nairobi Block 149/3557 | 0.019 |
| 19952/454 | Nairobi Block 149/3424 | 0.0195 |
| 19952/453 | Nairobi Block 149/3423 | 0.0195 |
| 19952/455 | Nairobi Block 149/3425 | 0.02 |
| 19952/456 | Nairobi Block 149/3426 | 0.02 |
| 19952/458 | Nairobi Block 149/3428 | 0.02 |
| 19952/457 | Nairobi Block 149/3427 | 0.02 |
| 19952/459 | Nairobi Block 149/3429 | 0.02 |
| 19952/460 | Nairobi Block 149/3430 | 0.02 |
| 19952/462 | Nairobi Block 149/3432 | 0.02 |
| 19952/461 | Nairobi Block 149/3431 | 0.02 |
| 19952/463 | Nairobi Block 149/3433 | 0.02 |
| 19952/464 | Nairobi Block 149/3434 | 0.02 |
| 19952/466 | Nairobi Block 149/3436 | 0.02 |
| 19952/465 | Nairobi Block 149/3435 | 0.02 |
| 19952/467 | Nairobi Block 149/3437 | 0.02 |
| 19952/468 | Nairobi Block 149/3438 | 0.02 |
| 19952/470 | Nairobi Block 149/3440 | 0.02 |
| 19952/469 | Nairobi Block 149/3439 | 0.02 |
| 19952/471 | Nairobi Block 149/3441 | 0.02 |
| 19952/472 | Nairobi Block 149/3383 | 0.02 |
| 19952/474 | Nairobi Block 149/3443 | 0.02 |
| 19952/473 | Nairobi Block 149/3442 | 0.02 |
| 19952/475 | Nairobi Block 149/3444 | 0.02 |
| 19952/476 | Nairobi Block 149/3445 | 0.02 |
| 19952/478 | Nairobi Block 149/3447 | 0.02 |
| 19952/477 | Nairobi Block 149/3446 | 0.02 |
| 19952/479 | Nairobi Block 149/3448 | 0.0195 |
| 19952/480 | Nairobi Block 149/3449 | 0.0195 |
| 19952/481 | Nairobi Block 149/3450 | 0.0195 |
| 19952/484 | Nairobi Block 149/3453 | 0.02 |
| 19952/485 | Nairobi Block 149/3454 | 0.02 |
| 19952/488 | Nairobi Block 149/3457 | 0.0191 |
| 19952/489 | Nairobi Block 149/3459 | 0.017 |
| 19952/491 | Nairobi Block 149/3460 | 0.024 |
| 19952/482 | Nairobi Block 149/3451 | 0.0195 |
| 19952/483 | Nairobi Block 149/3452 | 0.02 |
| 19952/486 | Nairobi Block 149/3455 | 0.02 |
| 19952/487 | Nairobi Block 149/3456 | 0.0191 |
| 19952/490 | Nairobi Block 149/3458 | 0.017 |
| 19952/751 | Nairobi Block 149/3461 | 0.024 |
| 19952/497 | Nairobi Block 149/3467 | 0.0185 |
| 19952/496 | Nairobi Block 149/3466 | 0.0185 |
| 19952/495 | Nairobi Block 149/3465 | 0.02 |
| 19952/494 | Nairobi Block 149/3464 | 0.0191 |
| 19952/493 | Nairobi Block 149/3463 | 0.0236 |
| 19952/492 | Nairobi Block 149/3462 | 0.022 |
| 19952/511 | Nairobi Block 149/3481 | 0.0185 |
| 19952/510 | Nairobi Block 149/3480 | 0.0185 |
| 19952/509 | Nairobi Block 149/3479 | 0.02 |
| 19952/508 | Nairobi Block 149/3478 | 0.02 |
| 19952/507 | Nairobi Block 149/3477 | 0.02 |
| 19952/506 | Nairobi Block 149/3476 | 0.02 |
| 19952/505 | Nairobi Block 149/3475 | 0.02 |
| 19952/504 | Nairobi Block 149/3474 | 0.02 |
| 19952/503 | Nairobi Block 149/3473 | 0.02 |
| 19952/502 | Nairobi Block 149/3472 | 0.02 |
| 19952/501 | Nairobi Block 149/3471 | 0.02 |
| 19952/500 | Nairobi Block 149/3470 | 0.02 |
| 19952/498 | Nairobi Block 149/3468 | 0.0185 |

| Old L.R. No. | New Parcel No. | Area (Ha.) |
|--------------|------------------------|------------|
| 19952/499 | Nairobi Block 149/3469 | 0.0185 |
| 19952/523 | Nairobi Block 149/3494 | 0.019 |
| 19952/522 | Nairobi Block 149/3493 | 0.019 |
| 19952/524 | Nairobi Block 149/3495 | 0.0205 |
| 19952/525 | Nairobi Block 149/3496 | 0.0205 |
| 19952/526 | Nairobi Block 149/3497 | 0.0205 |
| 19952/527 | Nairobi Block 149/3498 | 0.0205 |
| 19952/528 | Nairobi Block 149/3499 | 0.0205 |
| 19952/529 | Nairobi Block 149/3500 | 0.0205 |
| 19952/530 | Nairobi Block 149/3501 | 0.0205 |
| 19952/531 | Nairobi Block 149/3502 | 0.0205 |
| 19952/532 | Nairobi Block 149/3503 | 0.0205 |
| 19952/533 | Nairobi Block 149/3504 | 0.0205 |
| 19952/535 | Nairobi Block 149/3507 | 0.019 |
| 19952/534 | Nairobi Block 149/3506 | 0.019 |
| 19952/539 | Nairobi Block 149/3510 | 0.0205 |
| 19952/540 | Nairobi Block 149/3512 | 0.0196 |
| 19952/542 | Nairobi Block 149/3514 | 0.0241 |
| 19952/541 | Nairobi Block 149/3513 | 0.0275 |
| 19952/543 | Nairobi Block 149/3515 | 0.025 |
| 19952/537 | Nairobi Block 149/3508 | 0.019 |
| 19952/538 | Nairobi Block 149/3509 | 0.019 |
| 19952/583 | Nairobi Block 149/3555 | 0.0195 |
| 19952/584 | Nairobi Block 149/3556 | 0.019 |
| 19952/582 | Nairobi Block 149/3554 | 0.0205 |
| 19952/581 | Nairobi Block 149/3553 | 0.02 |
| 19952/579 | Nairobi Block 149/3551 | 0.0205 |
| 19952/580 | Nairobi Block 149/3552 | 0.02 |
| 19952/578 | Nairobi Block 149/3550 | 0.0205 |
| 19952/577 | Nairobi Block 149/3549 | 0.02 |
| 19952/575 | Nairobi Block 149/3547 | 0.0205 |
| 19952/576 | Nairobi Block 149/3548 | 0.0191 |
| 19952/574 | Nairobi Block 149/3546 | 0.0205 |
| 19952/573 | Nairobi Block 149/3545 | 0.017 |
| 19952/571 | Nairobi Block 149/3543 | 0.0205 |
| 19952/572 | Nairobi Block 149/3544 | 0.025 |
| 19952/570 | Nairobi Block 149/3542 | 0.0205 |
| 19952/569 | Nairobi Block 149/3541 | 0.02 |
| 19952/567 | Nairobi Block 149/3539 | 0.0205 |
| 19952/568 | Nairobi Block 149/3540 | 0.02 |
| 19952/566 | Nairobi Block 149/3538 | 0.0205 |
| 19952/565 | Nairobi Block 149/3537 | 0.02 |
| 19952/563 | Nairobi Block 149/3535 | 0.0205 |
| 19952/564 | Nairobi Block 149/3536 | 0.02 |
| 19952/562 | Nairobi Block 149/3534 | 0.0205 |
| 19952/559 | Nairobi Block 149/3531 | 0.0205 |
| 19952/558 | Nairobi Block 149/3530 | 0.0205 |
| 19952/555 | Nairobi Block 149/3527 | 0.0205 |
| 19952/556 | Nairobi Block 149/3528 | 0.02 |
| 19952/554 | Nairobi Block 149/3526 | 0.0205 |
| 19952/553 | Nairobi Block 149/3525 | 0.02 |
| 19952/551 | Nairobi Block 149/3523 | 0.0205 |
| 19952/552 | Nairobi Block 149/3524 | 0.02 |
| 19952/550 | Nairobi Block 149/3522 | 0.0205 |
| 19952/549 | Nairobi Block 149/3521 | 0.02 |
| 19952/547 | Nairobi Block 149/3519 | 0.0196 |
| 19952/548 | Nairobi Block 149/3520 | 0.02 |
| 19952/546 | Nairobi Block 149/3518 | 0.0175 |
| 19952/545 | Nairobi Block 149/3517 | 0.02 |
| 19952/544 | Nairobi Block 149/3516 | 0.018 |
| 19952/750 | Nairobi Block 149/3511 | 0.025 |
| 19952/749 | Nairobi Block 149/3570 | 0.02 |
| 19952/748 | Nairobi Block 149/3569 | 0.02 |
| 19952/747 | Nairobi Block 149/3568 | 0.02 |
| 19952/746 | Nairobi Block 149/3567 | 0.0364 |
| 27024/164 | Nairobi Block 149/3090 | 0.0287 |
| 29516/3 | Nairobi Block 149/1744 | 0.0411 |
| 29516/4 | Nairobi Block 149/1745 | 0.027 |
| 29516/5 | Nairobi Block 149/1746 | 0.027 |
| 29516/6 | Nairobi Block 149/1747 | 0.027 |
| 29516/7 | Nairobi Block 149/1748 | 0.027 |
| 29516/8 | Nairobi Block 149/1749 | 0.027 |

| Old L.R. No. | New Parcel No. | Area (Ha.) |
|--------------|------------------------|------------|
| 29516/9 | Nairobi Block 149/1750 | 0.027 |
| 29516/10 | Nairobi Block 149/1751 | 0.027 |
| 29516/11 | Nairobi Block 149/1752 | 0.027 |
| 29516/12 | Nairobi Block 149/1753 | 0.027 |
| 29516/13 | Nairobi Block 149/1754 | 0.027 |
| 29516/14 | Nairobi Block 149/1755 | 0.027 |
| 29516/15 | Nairobi Block 149/1756 | 0.027 |
| 29516/16 | Nairobi Block 149/1757 | 0.027 |
| 29516/17 | Nairobi Block 149/1758 | 0.027 |
| 29516/18 | Nairobi Block 149/1759 | 0.027 |
| 29516/19 | Nairobi Block 149/1760 | 0.027 |
| 29516/20 | Nairobi Block 149/1761 | 0.027 |
| 29516/21 | Nairobi Block 149/1762 | 0.027 |
| 29516/22 | Nairobi Block 149/1763 | 0.027 |
| 29516/23 | Nairobi Block 149/1764 | 0.027 |
| 29516/24 | Nairobi Block 149/1765 | 0.027 |
| 29516/25 | Nairobi Block 149/1766 | 0.027 |
| 29516/26 | Nairobi Block 149/1767 | 0.027 |
| 29516/27 | Nairobi Block 149/1768 | 0.027 |
| 29516/28 | Nairobi Block 149/1769 | 0.027 |
| 29516/29 | Nairobi Block 149/1770 | 0.027 |
| 29516/30 | Nairobi Block 149/1771 | 0.027 |
| 29516/31 | Nairobi Block 149/1772 | 0.027 |
| 29516/32 | Nairobi Block 149/1773 | 0.027 |
| 29516/33 | Nairobi Block 149/1774 | 0.027 |
| 29516/34 | Nairobi Block 149/1775 | 0.027 |
| 29516/35 | Nairobi Block 149/1776 | 0.027 |
| 29516/36 | Nairobi Block 149/1777 | 0.0337 |
| 29516/37 | Nairobi Block 149/1778 | 0.0225 |
| 29516/38 | Nairobi Block 149/1779 | 0.0225 |
| 29516/39 | Nairobi Block 149/1780 | 0.0225 |
| 29516/40 | Nairobi Block 149/1781 | 0.036 |
| 29516/41 | Nairobi Block 149/1782 | 0.0293 |
| 29516/42 | Nairobi Block 149/1783 | 0.023 |
| 29516/43 | Nairobi Block 149/1784 | 0.023 |
| 29516/44 | Nairobi Block 149/1785 | 0.0357 |
| 29516/45 | Nairobi Block 149/1786 | 0.0357 |
| 29516/46 | Nairobi Block 149/1787 | 0.025 |
| 29516/47 | Nairobi Block 149/1788 | 0.025 |
| 29516/48 | Nairobi Block 149/1789 | 0.0332 |
| 29516/49 | Nairobi Block 149/1790 | 0.0343 |
| 29516/50 | Nairobi Block 149/1791 | 0.025 |
| 29516/51 | Nairobi Block 149/1792 | 0.025 |
| 29516/52 | Nairobi Block 149/1793 | 0.0357 |
| 29516/53 | Nairobi Block 149/1794 | 0.0287 |
| 29516/54 | Nairobi Block 149/1795 | 0.024 |
| 29516/55 | Nairobi Block 149/1796 | 0.023 |
| 29516/56 | Nairobi Block 149/1797 | 0.023 |
| 29516/57 | Nairobi Block 149/1798 | 0.0301 |
| 29516/58 | Nairobi Block 149/1799 | 0.0242 |
| 29516/59 | Nairobi Block 149/1800 | 0.0203 |
| 29516/60 | Nairobi Block 149/1801 | 0.0294 |
| 29516/61 | Nairobi Block 149/1802 | 0.0368 |
| 29516/62 | Nairobi Block 149/1803 | 0.0412 |
| 29516/63 | Nairobi Block 149/1804 | 0.0253 |
| 29516/64 | Nairobi Block 149/1805 | 0.0235 |
| 29516/65 | Nairobi Block 149/1806 | 0.0304 |
| 29516/66 | Nairobi Block 149/1807 | 0.0235 |
| 29516/67 | Nairobi Block 149/1808 | 0.0447 |
| 29516/68 | Nairobi Block 149/1809 | 0.027 |
| 29516/69 | Nairobi Block 149/1811 | 0.0273 |
| 29516/70 | Nairobi Block 149/1810 | 0.0394 |
| 29516/71 | Nairobi Block 149/1812 | 0.03 |
| 29516/72 | Nairobi Block 149/2560 | 0.027 |
| 29516/73 | Nairobi Block 149/2561 | 0.027 |
| 29516/74 | Nairobi Block 149/2562 | 0.027 |
| 29516/75 | Nairobi Block 149/2563 | 0.027 |
| 29516/76 | Nairobi Block 149/2564 | 0.027 |
| 29516/77 | Nairobi Block 149/2565 | 0.078 |
| 29516/78 | Nairobi Block 149/2566 | 0.03 |
| 29516/79 | Nairobi Block 149/2567 | 0.03 |
| 29516/80 | Nairobi Block 149/2568 | 0.0391 |

| Old L.R. No. | New Parcel No. | Area (Ha.) |
|--------------|------------------------|------------|
| 29516/81 | Nairobi Block 149/2569 | 0.0459 |
| 29516/82 | Nairobi Block 149/2570 | 0.043 |
| 29516/83 | Nairobi Block 149/2571 | 0.0319 |
| 29516/84 | Nairobi Block 149/2572 | 0.0325 |
| 29516/85 | Nairobi Block 149/2573 | 0.0332 |
| 29516/86 | Nairobi Block 149/2574 | 0.1028 |
| 29516/87 | Nairobi Block 149/2575 | 0.0234 |
| 29516/88 | Nairobi Block 149/2576 | 0.0234 |
| 29516/89 | Nairobi Block 149/2577 | 0.0387 |
| 29516/90 | Nairobi Block 149/2578 | 0.0279 |
| 29516/91 | Nairobi Block 149/2579 | 0.0243 |
| 29516/92 | Nairobi Block 149/2580 | 0.0243 |
| 29516/93 | Nairobi Block 149/2581 | 0.0243 |
| 29516/94 | Nairobi Block 149/2582 | 0.0243 |
| 29516/95 | Nairobi Block 149/2583 | 0.0243 |
| 29516/96 | Nairobi Block 149/2584 | 0.0243 |
| 29516/97 | Nairobi Block 149/2585 | 0.0243 |
| 29516/98 | Nairobi Block 149/2586 | 0.0243 |
| 29516/99 | Nairobi Block 149/2587 | 0.0262 |
| 29516/100 | Nairobi Block 149/2588 | 0.0246 |
| 29516/101 | Nairobi Block 149/2589 | 0.049 |

| Old L.R. No. | New Parcel No. | Area (Ha.) |
|--------------|------------------------|------------|
| 29516/102 | Nairobi Block 149/2590 | 0.0273 |
| 19952/429 | Nairobi Block 149/3399 | 0.02 |
| 29516/2 | Nairobi Block 149/2611 | 4.425 |
| 19952/755 | Nairobi Block 149/1922 | 0.03 |
| 19952/756 | Nairobi Block 149/1923 | 0.03 |
| 27024/32 | Nairobi Block 149/3001 | 0.0355 |
| 27024/33 | Nairobi Block 149/3002 | 0.0333 |

NAIROBI BLOCK 47

KAREN MUTUINI

| Old L.R. No. | New Parcel No. | Area (Ha.) |
|--------------|-----------------------|------------|
| 1161/3 | Nairobi Block 47/1666 | 0.8903 |
| 1161/4 | Nairobi Block 47/1641 | 9.799 |

Dated the 17th May, 2024.

Alice Wahome,
 Cabinet Secretary for Lands,
 Public Works, Housing and Urban Development.

Note: Maps at the end of Gazette.

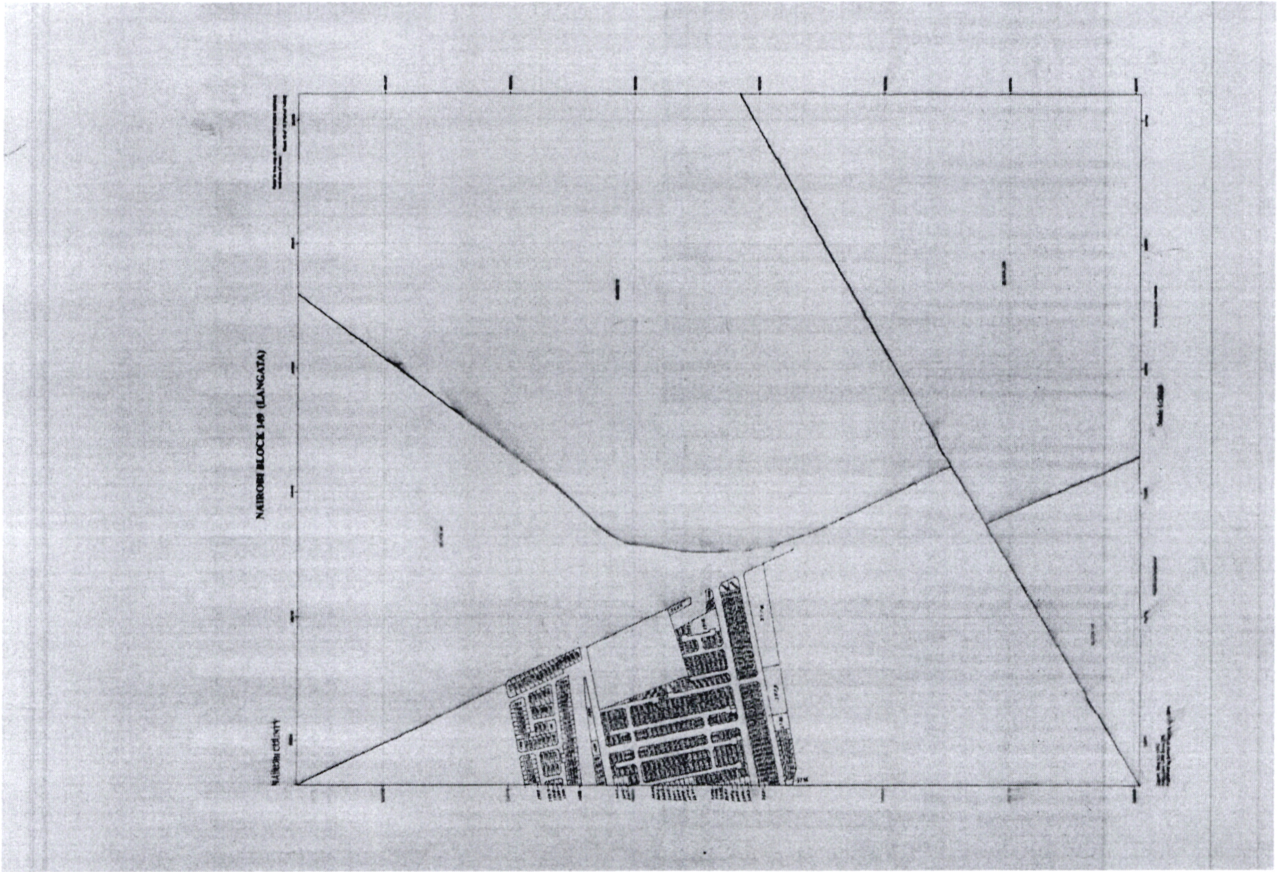

NAIROBI BLOCK 47 (KAREN MUTUINI)

Refer to the map in RESIDENCY INDEX SERIES
and date of issue Sheet 17 of 19 (Part of 1463)

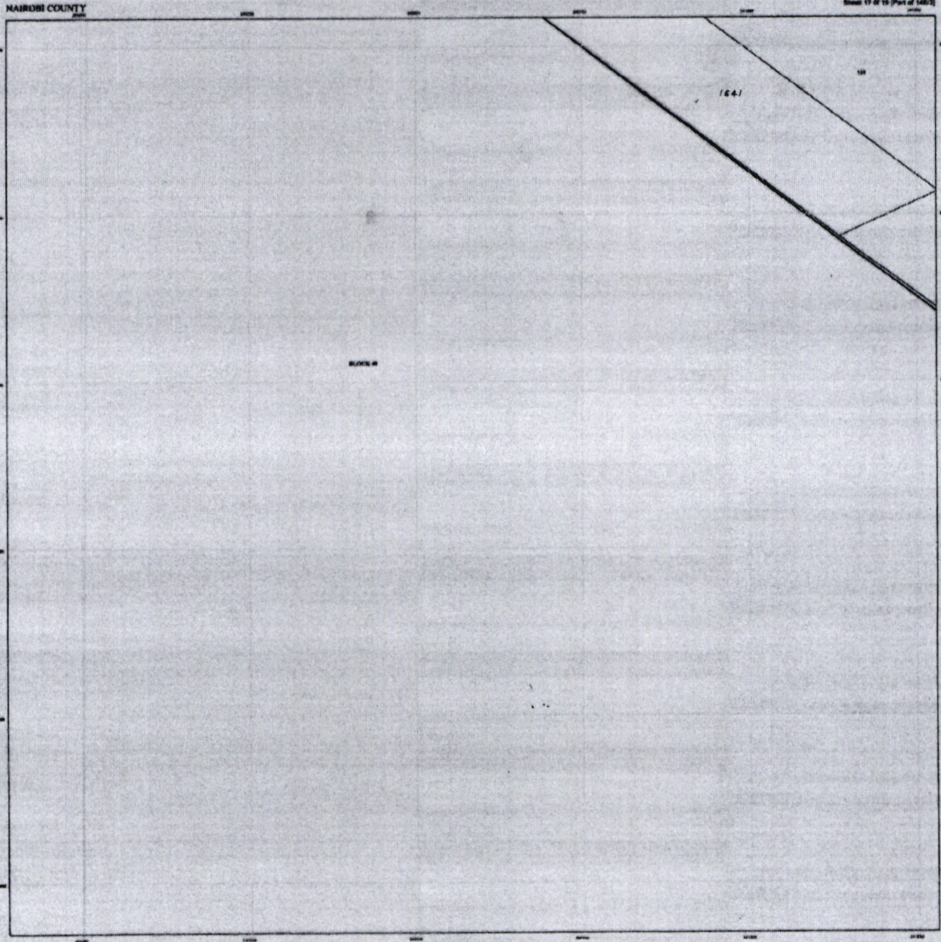

From Sheet No. 1288
Projection UTM Zone 37E
Published by Survey of Kenya May, 2002

STATE BOUNDARY

SCALE 1 : 2500

ONE INCHES

SECOND EDITION
Compiled by Survey of Kenya May, 2002
Superseded the 1st Edition, 1988
(See Technical File)

| SL | DATE | NO. IN | NO. OF(S) | PL. NO. | PL. NO. | NO. OF(S) | NO. OF(S) |
|----|------|--------|-----------|---------|---------|-----------|-----------|
| 1 | 1988 | 1288 | 1288 | 1288 | 1288 | 1288 | 1288 |
| 2 | 2002 | 1288 | 1288 | 1288 | 1288 | 1288 | 1288 |

